

Please read these instructions carefully. THIS IS A NEWLY DESIGNED POTENTIOMETER

FITTING INSTRUCTION - REPLACING THE SWITCH/HANDLE

UKKIT 5 & 7

1. Remove the green control knob from the handle. Insert the allen key supplied into the hole in the edge of the control knob and loosen the screw buried inside.
2. Undo and remove the nut and shake-proof washer which are visible when the control knob has been taken off.
3. Remove the fixings shown in fig1, marked "A", "B" & "E". Do not remove the 2 screws marked "C"
NOTE - Be prepared, these fixings are quite tight. Please ensure your screw driver is a good fit in the screw heads.
4. Remove the top half of the handle. The lower half will remain attached to the trolley frame.
5. Note the position of the old switch in the lower half of the handle.
6. Lift the Blue Switch out and remove the small connector block and switch from the handle wire by cutting the three wires as close as possible to the connector block.
7. Strip the outer cover from all three wires to bare the inner wire for a length of approximately 5mm/1/4".
8. Carefully fit bared wires into the black connector block below the green circuit board, which is attached to the blue switch unit (potentiometer). With the circuit board sitting flush to letter F (see diagram) the wires go green, blue, red. Red being uppermost. Once the wires are slotted in place, please tighten screws at base of black connector block.
9. When slotting the switch in place please make sure that the green circuit board is flush to letter F (see diagram). Position the new switch in the lower handle. The handle is shaped to support the switch in the correct position. Hold the switch steady with your thumb and lay the wiring in the handle. **The wiring should be pushed into the cable guides provided.**
10. Place the upper half of the handle in position, ensuring the wire is not trapped.
11. Insert the 4 screws and secure the 2 halves of the handle together using the 4 nuts (fig 1 - B).
12. Insert and tighten the long self tapping screw (fig 1 - E), into the lower half of the handle.
13. Fit the remaining 2 self tapping screws into the top half of the handle (fig 1 - A).
14. Fit the new shake proof washer and nut to the switch (fig 1 - D), and tighten the nut firmly.
15. Push the control knob onto the switch spindle and secure it using the allen key. Do not over tighten; doing so may distort the control knob.

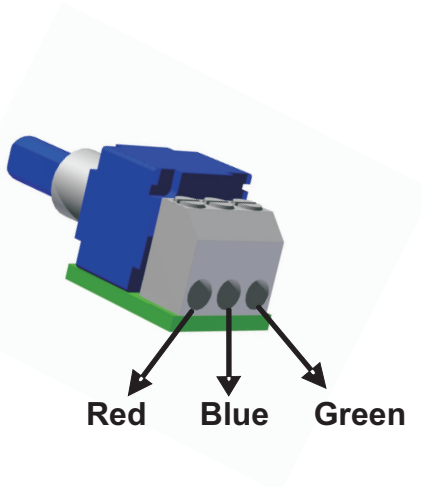
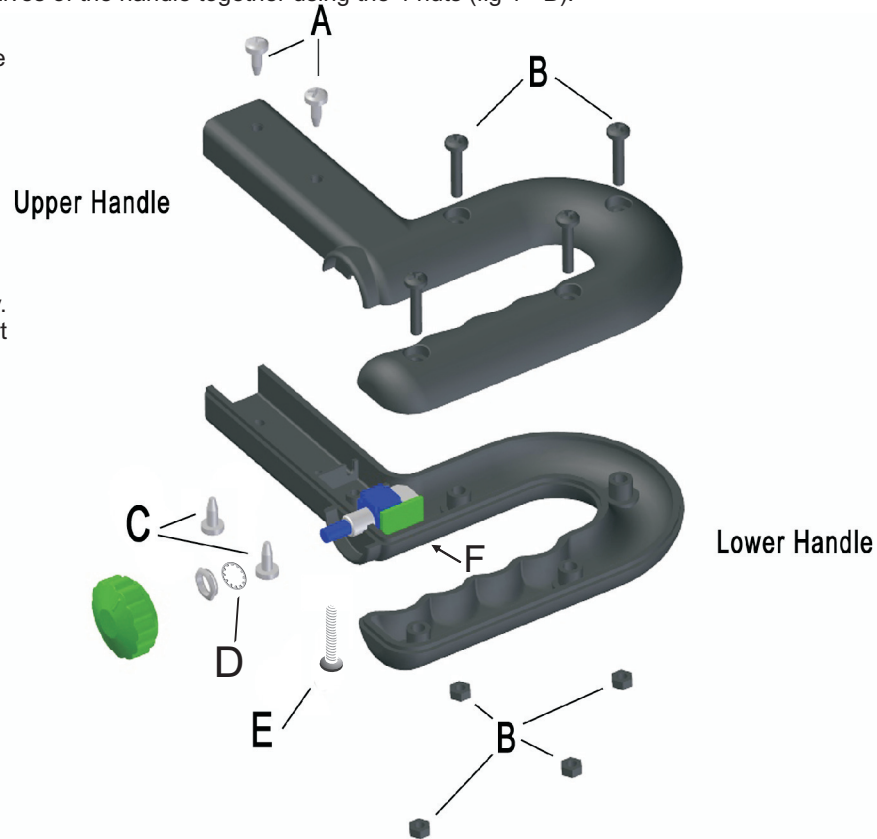

If you have any queries, please contact our technical team on 01795 413830